

DOOR NUMBER	QTY	OPENING WIDTH	OPENING HEIGHT	ACTUAL WIDTH	ACTUAL HEIGHT	MODEL	JAMB W/S	MOUNTING ANGLE BRKT	LOOK	PANELS WIDE	PANELS HIGH	SECTION NUMBER	OPEN FOR GLASS							
												1	2	3	4	5	6	7	8	

JOB: \_\_\_\_\_  
 CONTR: \_\_\_\_\_  
 ARCH: \_\_\_\_\_

NR: 2904070



# THERMASEAL STANDARD

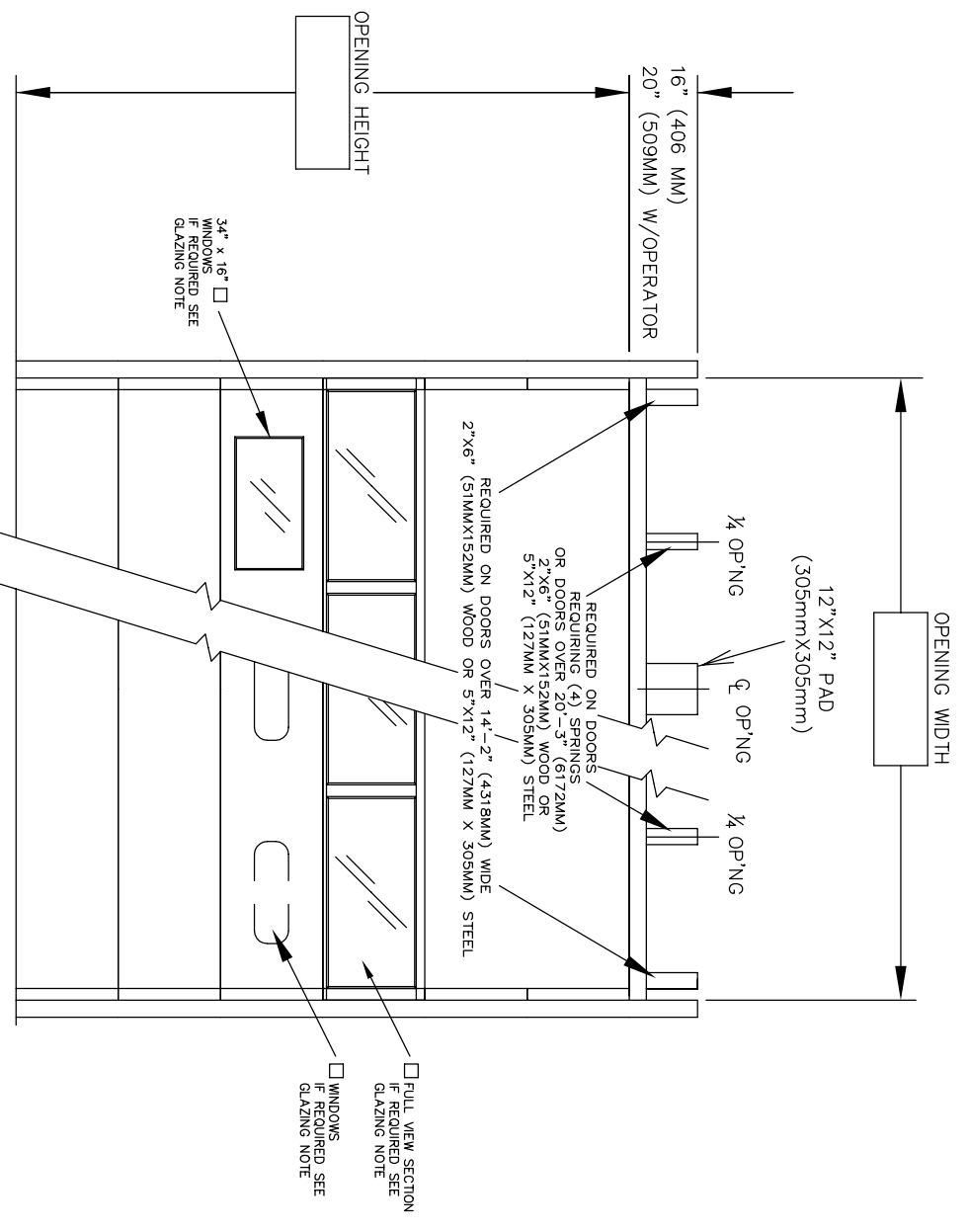

## INTERIOR ELEVATION

1) DOORS SHALL BE THERMASEAL SECTIONAL OVERHEAD TYPE RAYNOR SERIES STANDARD. AS MANUFACTURED BY RAYNOR GARAGE DOOR CO., SECTIONS SHALL BE 1 3/4" (44.5mm) THICK, ROLL-FORMED FROM COMMERCIAL QUALITY HOT DIPPED GALVANIZED STEEL PER ASTM-924 AND A-653, DOOR SECTIONS CONSTRUCTED OF 25 GAUGE EXTERIOR, AND 26 GAUGE INTERIOR. STUCCO-EMBOSSSED BEV-EDGED JOINTS NOT MET SEAL BOTTOM FOR AN EFFECTIVE THERMAL CORE EXTERIOR AND INTERIOR SKINS TO BE SEPERATED BREAK JOINT SEALS ARE USED TO COMPLETE A WEATHER-TITE SEAL. ALONG THE ENTIRE SECTION JOINTS, END STILES TO BE 16 GAUGE. SECTIONS TO HAVE CONTINUOUS 20 GA. HARDWARE STIPS. WHEN TESTED IN ACCORDANCE WITH ASTM-C-518, THERMASEAL HAS THE FOLLOWING ENERGY VALUES: R-VALUE = 16.4 AND U-VALUE = .061 TO ROLL-FORMING WITH A TWO COAT PROCESS OF BAKED ON POLYESTER FINISH OVER EPOXY PRIMER (WHITE OR DARK KYNAR BROWN) EXTERIOR AND WHITE INTERIOR.

- FULLVIEW SECTIONS - SECTIONS SHALL BE MADE FROM 6063T5 EXTRUDED ALUMINUM STILE AND RAIL CONSTRUCTION GLASS ENCASED AND HELD IN PLACE WITH SELF-ALIGNING RIGID VINYL GLAZING RETAINER. FINISH-TO MATCH DOOR SECTIONS. GLAZING TO BE 1/2" DSB INSULATED OR 1/8" DSB GLASS.
- GLAZING (AS SHOWN) - 2 1/4" (61.0MM) X 8" (203MM) X 1/8" 3/16" 1/4" (5/8") RUBBER BY RAYNOR
- GLAZING (AS SHOWN) - 3/4" (86.36MM) X 1/6" (40.64MM) X 1" INSULATED DSB GLASS
- LOCKING - CREMONE TYPE BOLT ENGAGES SLOT IN TRACK, \_\_\_\_\_ HAND SIDE. FIVE PIN TUMBLER CYLINDER OUTSIDE - NIGHT LATCH INSIDE. LOCKING - SPRING LOADED SLIDE BOLT ENGAGES SLOT IN TRACK. OPERABLE FROM INSIDE ONLY - MAY BE MOUNTED EITHER SIDE
- LOCKING - OMIT LOCK.

LOCKS SHOULD NOT BE SUPPLIED WITH AN ELECTRIC OPERATED DOOR WITHOUT A LOCK INTERLOCK SWITCH.

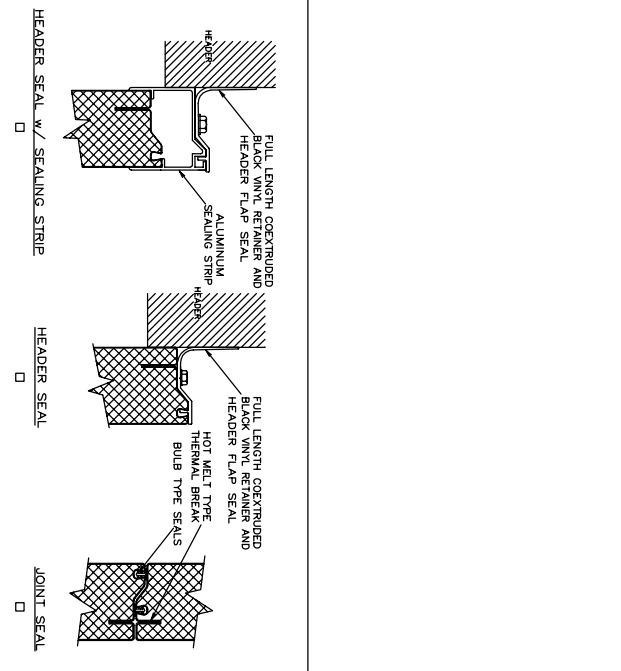

DOOR NUMBER	QTY	OPENING		ACTUAL		MODEL	JAMB MOUNTING		LOCK	PANELS WIDE	SECTION NUMBER OPEN FOR GLASS						
		WIDTH	HEIGHT	WIDTH	HEIGHT		W / S	M ANGLE/BRKT			1	2	3	4	5	6	7

JOB:  
DISTR:  
CONTR:  
ARCH:



NR: 2904070

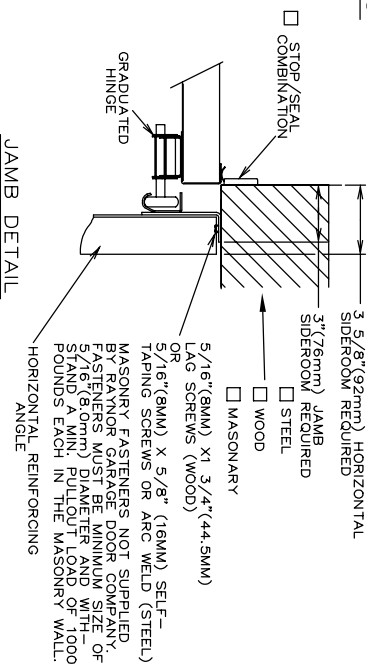
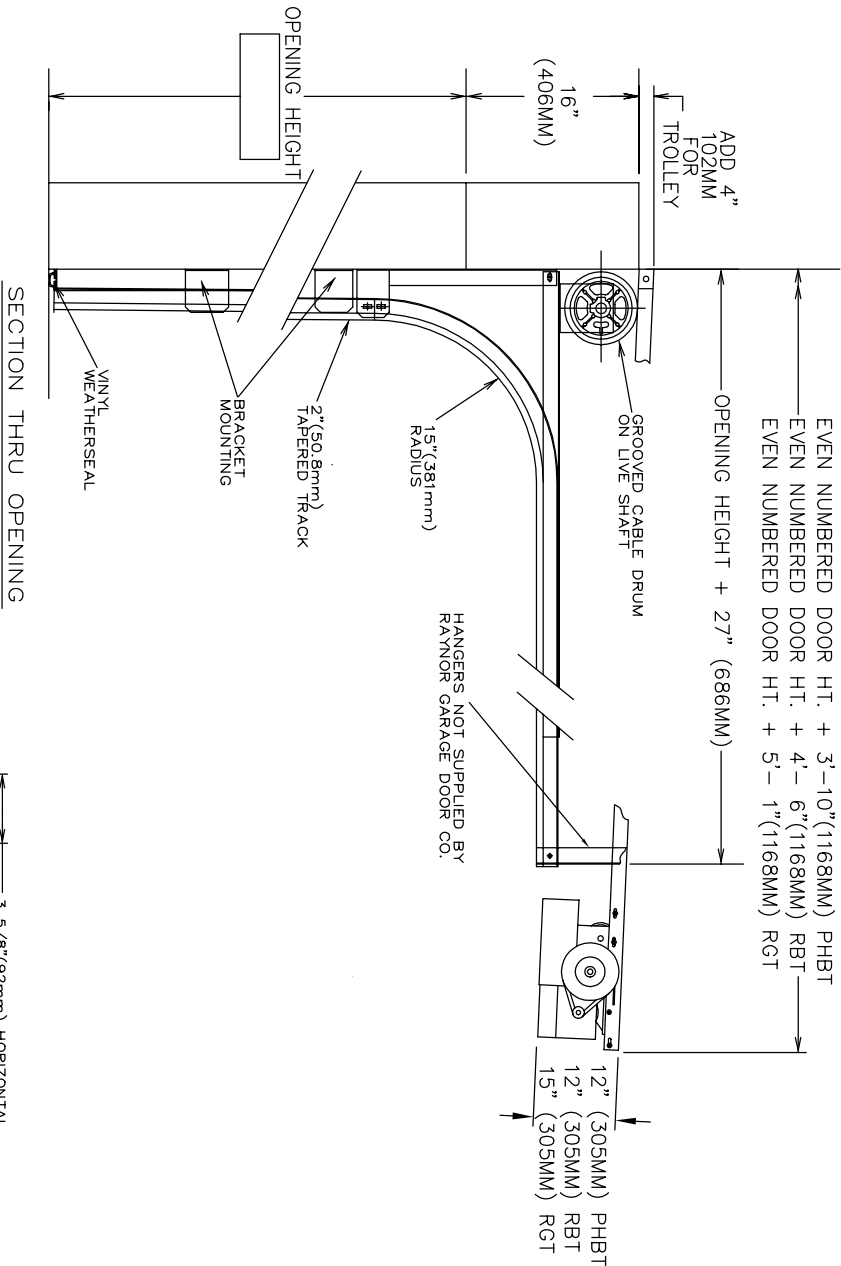

- RAYNOR POWERHOIST BASIC (PHBT) 1/2 H.P., 115 VOLT, SINGLE PHASE
- RAYNOR POWERHOIST STANDARD (RBT) \_\_\_ H.P., \_\_\_ VOLT, \_\_\_ PHASE
- RAYNOR POWERHOIST OPTIMA (RGT) \_\_\_ H.P., \_\_\_ VOLT, \_\_\_ PHASE
- WIRING TYPE-SR2 WIRING. MOMENTARY CONTACT OPEN/CLOSE/STOP. SAFETY EDGE TO REVERSE.
- WIRING TYPE-SPECIAL (NOT AVAILABLE WITH PHBT OPERATORS) SPECIFY SPECIAL WIRING TYPE \_\_\_\_\_
- PNEUMATIC SAFETY EDGE TO REVERSE
- ELECTRIC SAFETY EDGE TO REVERSE
- THRU-BEAM PHOTO EYES

ANSI/UL325 REQUIRES THE MOTOR OPERATOR BE MOUNTED A MINIMUM OF 8' ABOVE THE FLOOR OR GUARDING OF THE MOTOR OPERATOR TO PREVENT INJURY.(GUARDS BY OTHERS).

TRACKS- 2" (50.8mm) HOT-DIPPED GALVANIZED TRACK PER ASTM A-653. TRACK FASTENERS FOR MOUNTING TO JAMB MUST BE GALVANIZED TO JAMB HORIZONTAL TRACK TO BE ADEQUATELY REINFORCED WITH CONTINUOUS ANGLE.

HARDWARE- HINGES AND BRACKETS MADE FROM GALVANIZED STEEL. TRACK ROLLERS SHALL HAVE TEN 1/4" (6.4mm) DIAMETER HARDENED STEEL BALLS PER ROLLER.

SPRING COUNTERBALANCE- HEAVY DUTY OIL-TEMPERED WIRE TORSION SPRINGS ON A CONTINUOUS BALL BEARING CROSS-HEADER SHAFT GALVANIZED AIRCRAFT TYPE LIFTING CABLES WITH MIN. SAFETY FACTOR OF 5 TO 1.